

**Thermo Scientific Nunc  
Immuno Washer  
8 and 12 channel washer  
User Guide**

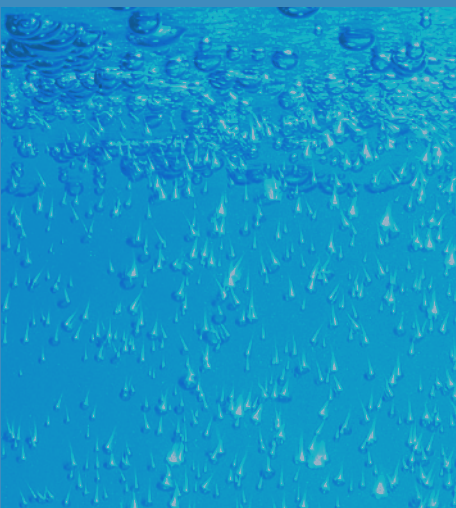

## Labo Baza

nowoczesne wyposażenie laboratorium

ul. Topolowa 5

62-002 Jelonek k/Poznań

tel.: 061 812 57 45

fax: 061 812 57 25

e-mail: [biuro@labobaza.pl](mailto:biuro@labobaza.pl)

[www.labobaza.pl](http://www.labobaza.pl)

**nunc**

**Thermo**  
SCIENTIFIC



# Thank you for purchasing this Thermo Scientific Nunc Immuno Washer

## Operating Instructions

1. Connect the inlet marked “fill” on the back of the housing to a source of washing solution (Fig. 2).
2. Connect the inlet marked “vac” on the back of the housing to a vacuum source (Fig. 2).
3. Place the washing cannulae of the Thermo Scientific Nunc Immuno Washer in the wells of a Thermo Scientific Nunc MicroWell plate or micro strip with the black adjustment screws on the Nunc™ MicroWell plate.
4. Press the knob on the upper part of the housing to initiate each desired washing cycle.
5. Move the Nunc Immuno™ Washer to the next row or column and repeat the procedure.

## Note

- Please press the knob slightly each time you wash, since prolonged activation causes liquid overflow.
- If necessary the liquid flow can be adjusted by means of a tube clamp, limiting the flow of washing solution.
- It will also be possible to wash in the “traditional” way by having the washing cannulae at the top of the wells in the starting position. A pressure on the knob will fill the wells of the micro plate. When you stop pressing the knob the filling is discontinued, then the cannulae can be lowered into the wells in order to empty the wells.
- This traditional filling method can also be used to dispense a solution in the wells or to keep them filled after the washing procedure.
- The Immuno Washer fits the flat bottomed MicroWell plates and strips. For use with other well shapes, the depth of the washing pins in the well may be adjusted using the screws on each side of the pins.

## Important

- The distance of the washing pins to the well bottom must be the same at both sides or the wells will be unevenly filled.  
This would cause inefficient washing and overflow. To measure the depth of the washing pins in the wells, a ruler is supplied with every Immuno Washer (Fig. 1).
- It is important to rinse the washer with distilled water after each use. Otherwise the cannulae may clog. Should clogging occur the wire supplied with the washer can be used for cleaning the cannulae.
- After removal of the obstruction from the washing cannulae, we would recommend cleaning inside the washer. To do this, connect the vacuum to the “fill” inlet, press the knob briefly and the interior is cleaned; then remove the vacuum from the “fill” inlet.
- Except for the above, the Immuno Washer needs no special maintenance, but it may be necessary to replace the O-rings and/or the spring after prolonged use (Fig. 3). For this purpose a spare part kit is available (Cat. No. 455493).
- The recommended working vacuum is 80 mm Hg.

## Warranty

The guarantee for the Immuno Washer covers defects in materials for two years from date of delivery. During this period any defective materials will be replaced at no charge. Labor costs in connection with repair of these defects will be provided at no charge.

**Fig. 1**

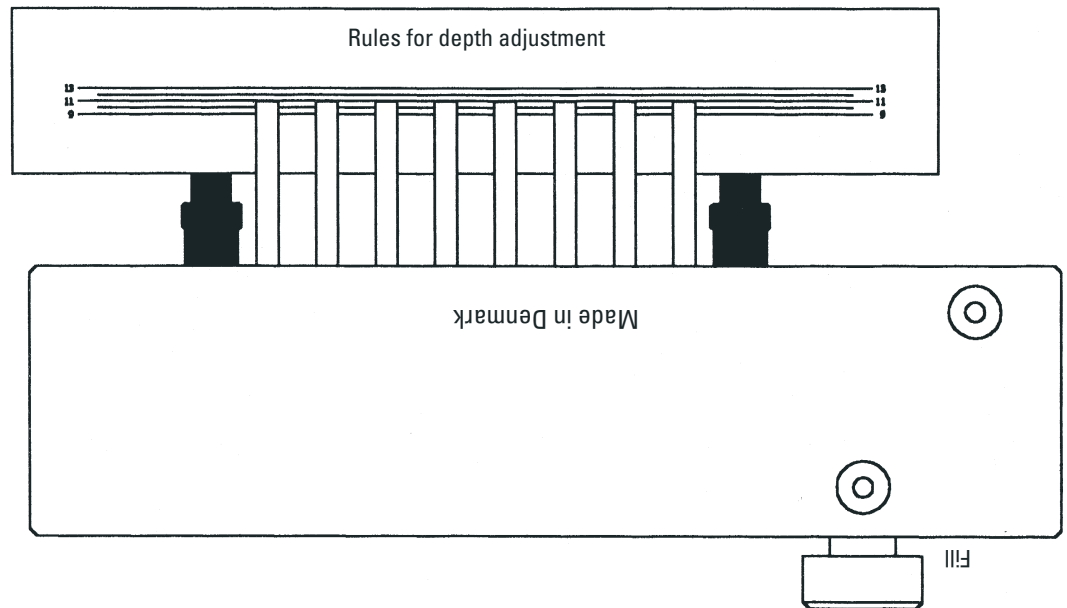

### **Adjustment of Depth**

In order to adjust the depth of the washing pins in the wells, use the ruler as shown on the above drawing. The lower edge of the ruler is to be pressed against the two screws of the washer.

Please make sure that the distance from the washing pins to the well bottoms is minimum 0.5 mm, and that the distance is the same at both ends.

NB: The washer is pre-set to fit flat bottomed MicroWell plates and modules. If micro plates of other brands or well configurations are used or in case that the screws have been turned, the depth should be adjusted.

**Fig. 2**

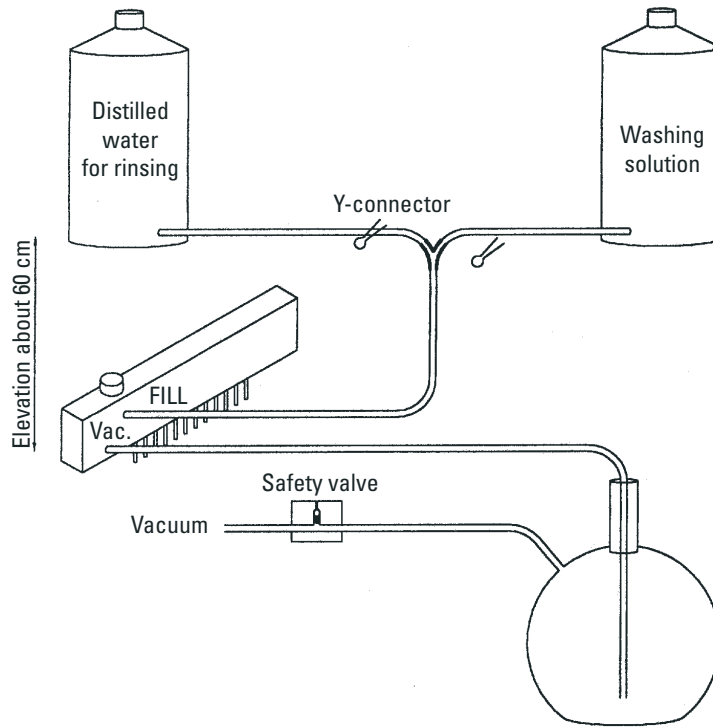

**Fig. 3**

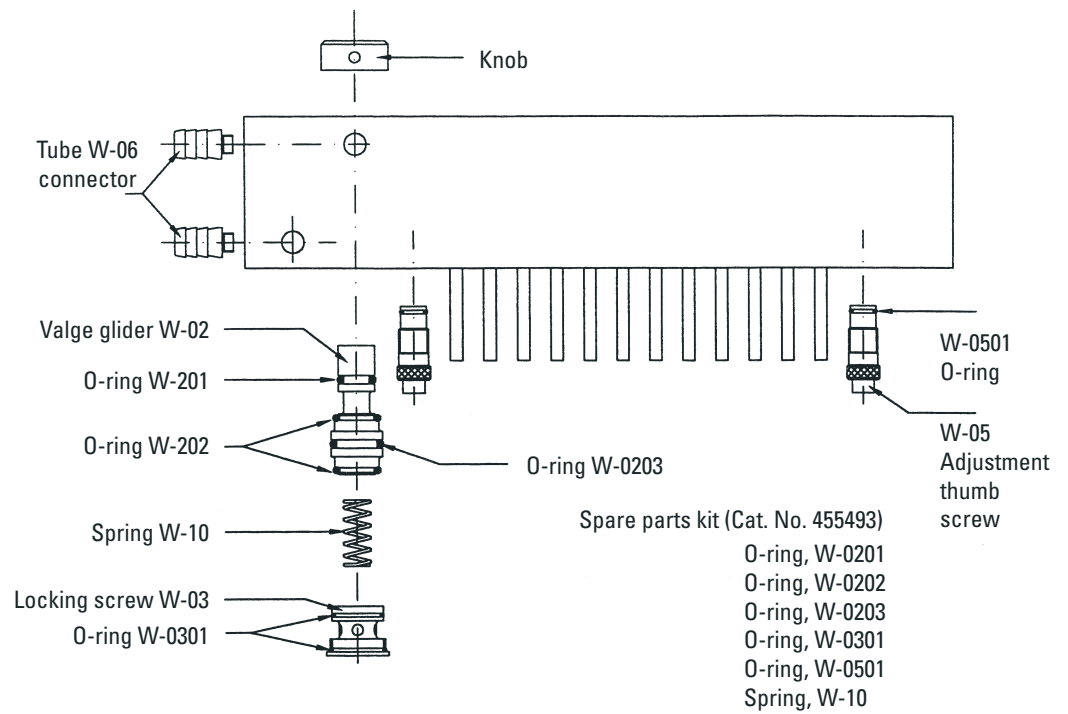

**Description and catalog number for ordering**

**Thermo Scientific Nunc Immuno Washer**

**Cat. No. Description**

---

470174	8 channel washer for 96 well MicroWell plates or strips
470175	12 channel washer for 96 well MicroWell plates or strips

**Thermo Fisher Scientific**

Kamstrupvej 90  
4000 Roskilde  
Denmark

[www.thermoscientific.com](http://www.thermoscientific.com)

**Labo Baza**

**nowoczesne wyposażenie laboratorium**

ul. Topolowa 5  
62-002 Jelonek k/Poznania  
tel.: 061 812 57 45  
fax: 061 812 57 25  
e-mail: [biuro@labobaza.pl](mailto:biuro@labobaza.pl)  
**[www.labobaza.pl](http://www.labobaza.pl)**

MNLSPIMMUNOWASH 1110

**Thermo**  
SCIENTIFIC